



VETROMARKET

di Francesco Vistocco

**LA PIU' MODERNA TECNOLOGIA APPLICATA ALLA TRASPARENZA,
SOLUZIONI E SISTEMI TECNICI PER IL VETRO.**

ELEGANZA, ESTETICA, DESIGN E FUNZIONALITA'.

VETROMARKET



VETROMARKET

di Francesco Vistocco

Pensilina in vetro Presa

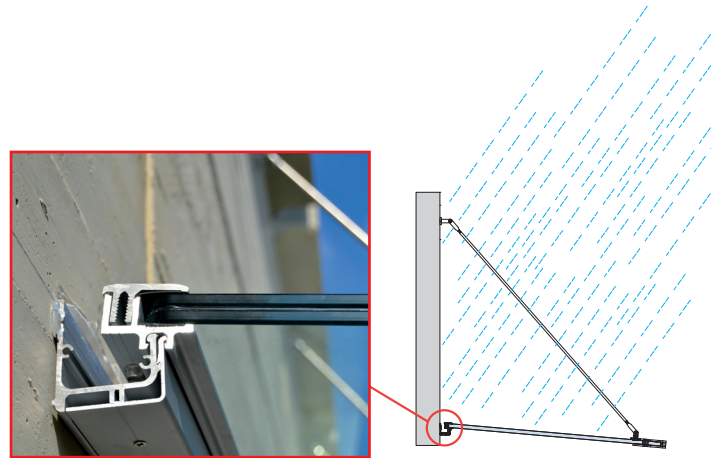
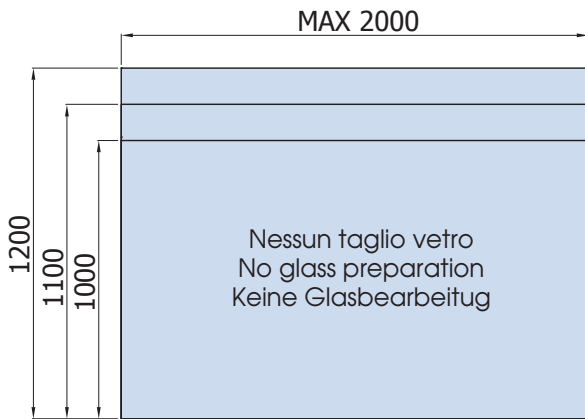
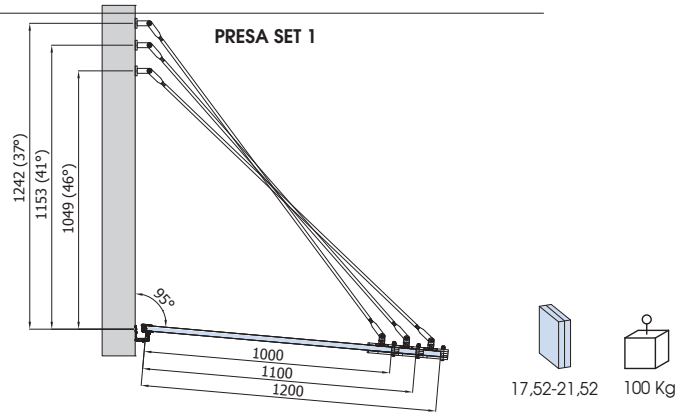
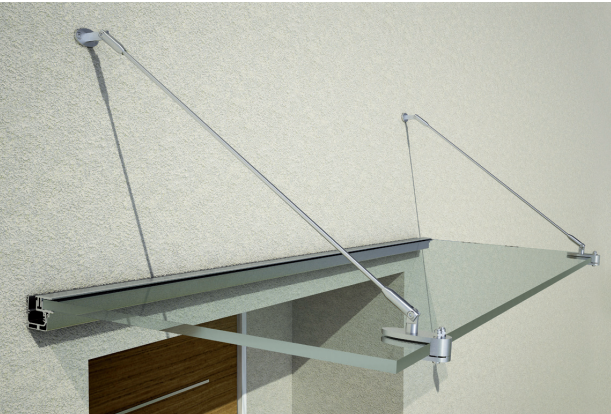

Componenti/Components/Einzelteile

ES-G2083E3

Punto di fissaggio superiore
Upper fastening point
Befestigungspunkt

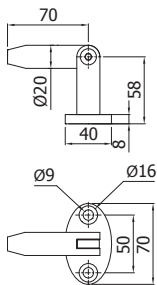

Presca-morsa

Pinza di fissaggio vetro
Fixing clamp glass with mounting link
Klemhalter mit Lasche

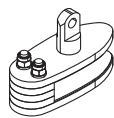

per vetro da 17,52
For glass 17,52
mit Glas 17,52

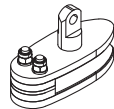

per vetro da 21,52
For glass 21,52
mit Glas 21,52

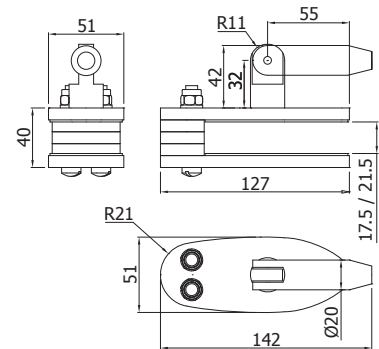

Presca-Tappo

Tappo laterale
con scarico acqua
Side endcap for gutter
Endkappe für Wasserabweiser



ES-G2083E

Barra tirante
Connecting rod
Zugstange Lagerlänge

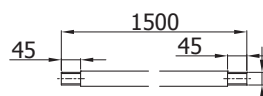

Presca-Profilo

Presca profilo gronda, sostiene il vetro ed evita le infiltrazioni d'acqua
Wall connecting profile with rain gutter
Wandanschlussprofil mit Wasserabweiser

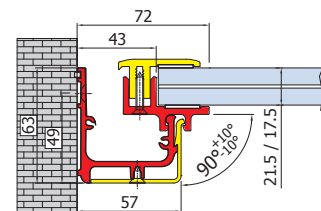

IX = Acciaio inox satinato
Satin stainless steel
Edelstahl matt



AN = Alluminio anodizzato
Aluminium anodised
Aluminium Silberfarbig



VETROMARKET

di Francesco Vistocco

Pensilina in vetro Tecno



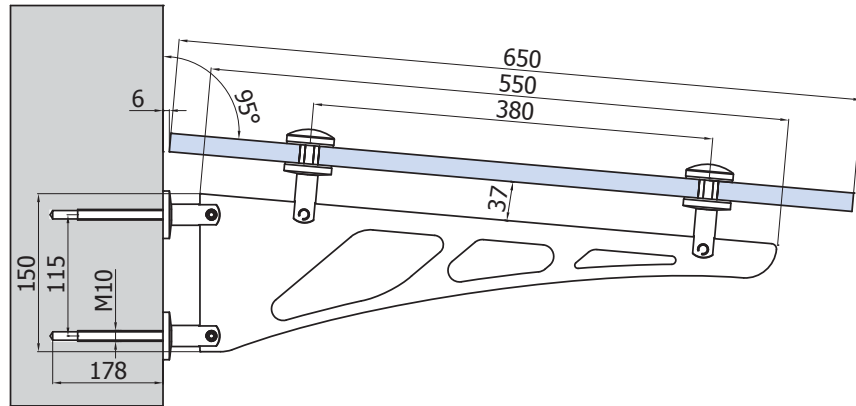
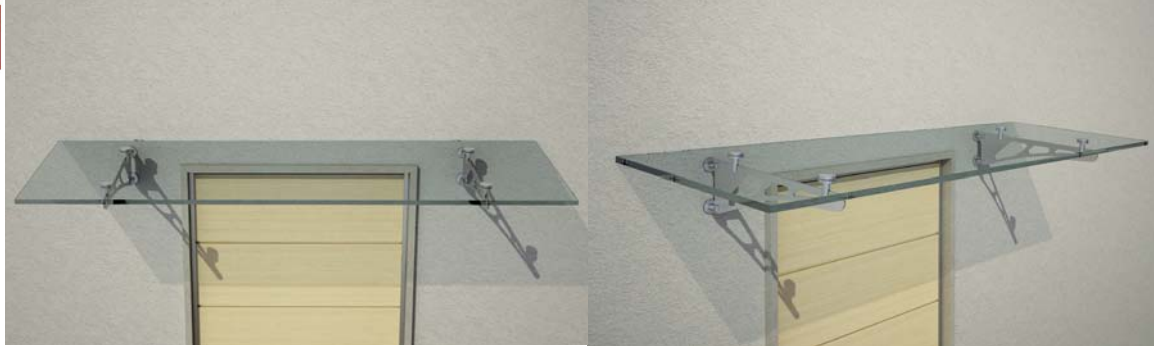

TECNO SET 1

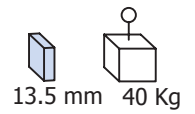
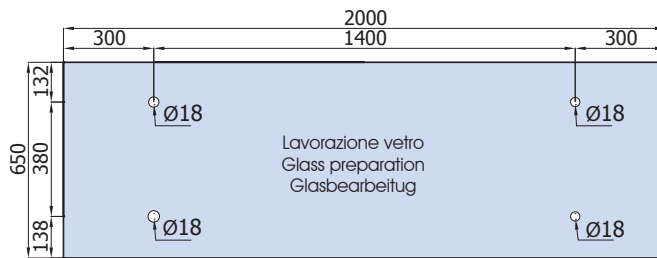
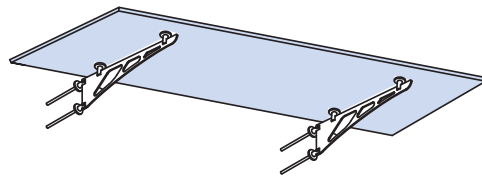

TECNO SET 2

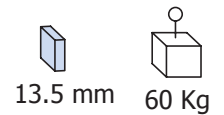
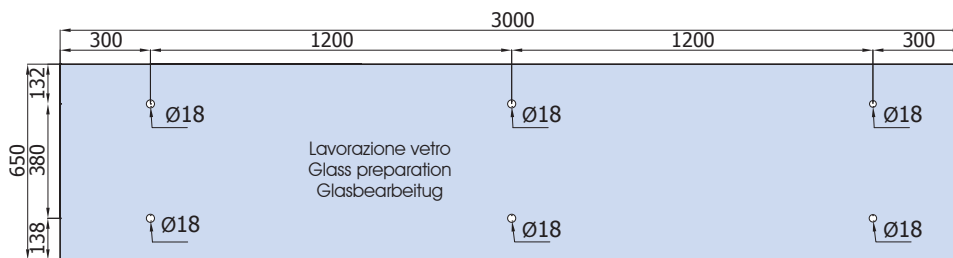
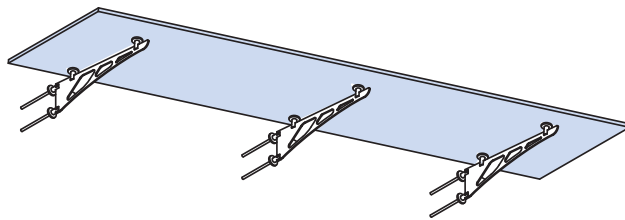

IX = Acciaio inox satinato
Satin stainless
Edelstahl matt



VETROMARKET

di Francesco Vistocco

Pensiline in vetro Sky / Ecosky



ECOSKY SET 1 SMALL

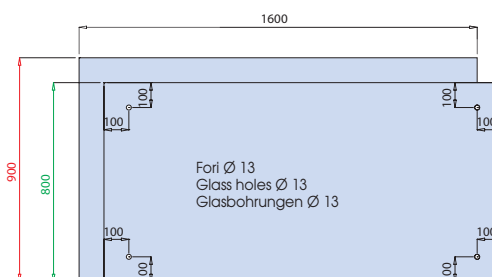
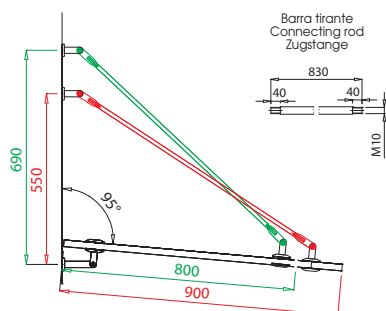

Vetro / Glass / Glas: 2 x 8
Stratificato temperato / Heat strengthened glass / TVG
Fori vetro / Glass holes / Lochbohrungen: 20 mm

ECOSKY SET 2 SMALL

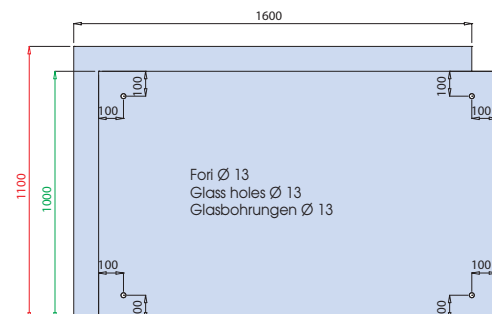
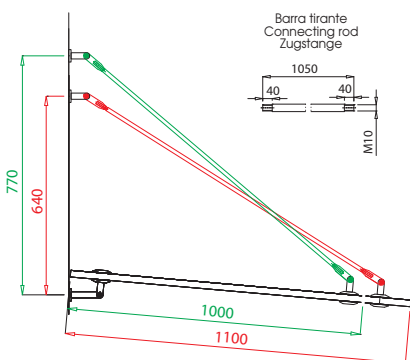

Vetro / Glass / Glas: 2 x 8
Stratificato temperato / Heat strengthened glass / TVG
Fori vetro / Glass holes / Lochbohrungen: 20 mm

IX = Acciaio inox satinato
Satin stainless steel
Edelstahl matt

PENSILINE IN VETRO E BALAUSTRATE
GLASS RAILS SYSTEMS AND
PROFILES FOR GLASS RAILINGS



VETROMARKET

di Francesco Vistocco

ECOSKY SET 3 MEDIUM

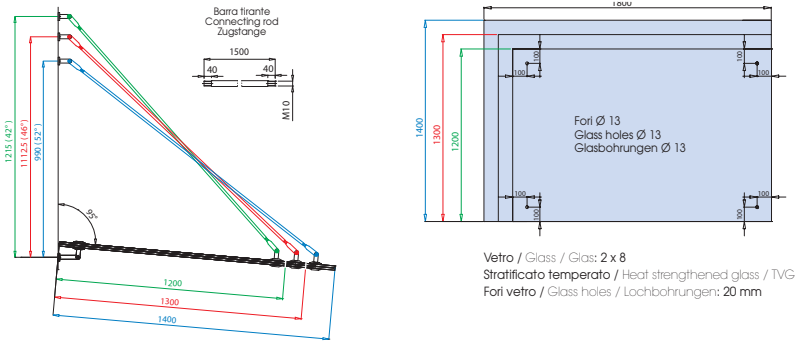

SKY M10 SET 4

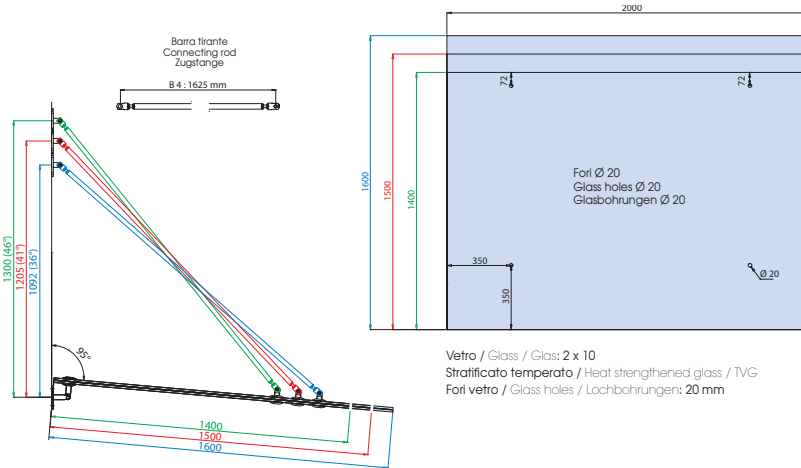

SKY M10 SET 5

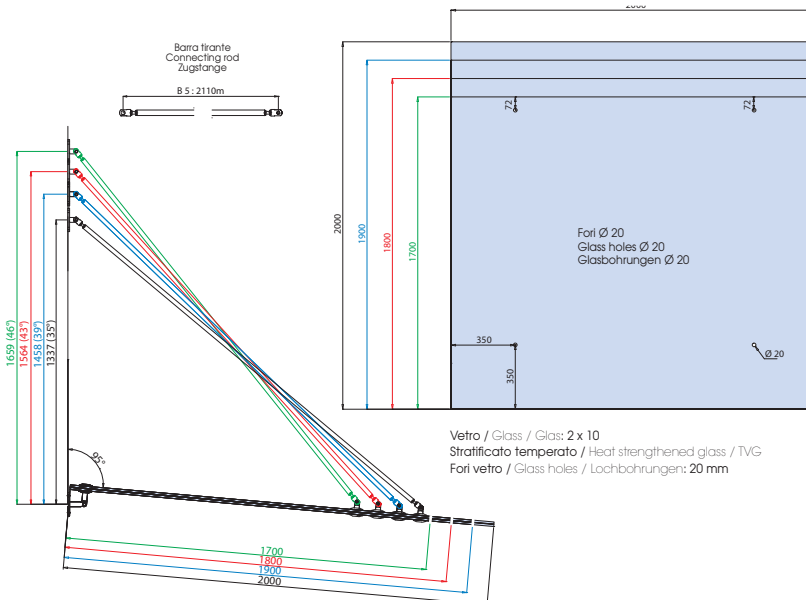



Pensiline in vetro Sky / Ecosky



ES-G2083E3

Punto di fissaggio superiore per Ecosky set 1, set 2, set 3.
Upper fastening point for Ecosky set 1, set 2, set 3.
Befestigungspunkt oben für Ecosky set 1, set 2, set 3.

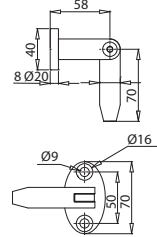

ES-G2083E2

Fissaggio a punto Ø 58 per Ecosky set 1, set 2, set 3. Fissaggio a punto sul vetro Ø 58 mm.
Point fitting Ø 58 for Ecosky set 1, set 2, set 3. Point fitting Ø 58 mm.
Punkthalter Ø 58 für Ecosky set 1, set 2, set 3. Punkthalter Ø 58 mm.

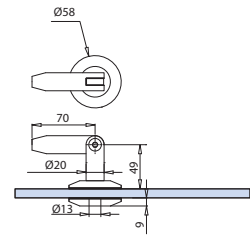

ES-G2083E1

Punto di fissaggio inferiore per Ecosky set 1, set 2, set 3.
Lower fastening point for Ecosky set 1, set 2, set 3.
Befestigungspunkt unten für Ecosky set 1, set 2, set 3.

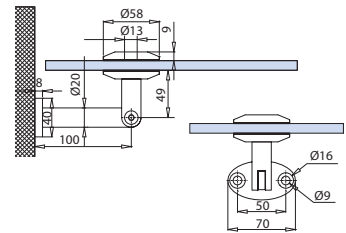

ES-G2083E - B1 (830 mm)

Barra tirante lunghezza standard per Ecosky set 1.
Connecting rod standard length for Ecosky set 1.
Zugstange Lagerlänge für Ecosky set 1.

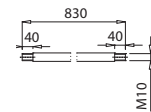

ES-G2083E - B2 (1050 mm)

Barra tirante lunghezza standard per Ecosky set 2.
Connecting rod standard length for Ecosky set 2.
Zugstange Lagerlänge für Ecosky set 2.

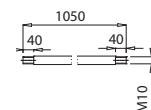

ES-G2083E (1500 mm)

Barra tirante lunghezza standard per Ecosky set 3.
Connecting rod standard length for Ecosky set 3.
Zugstange Lagerlänge für Ecosky set 3.

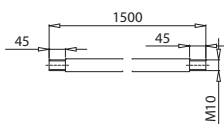

S-100

Piastra di fissaggio superiore per Sky set 4 e set 5.
Upper fastening plate suitable for Sky set 4, set 5.
Befestigungsplatte oben passend für Sky set 4, set 5.

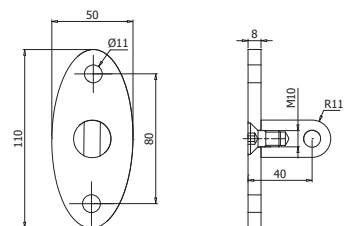

IX = Acciaio inox satinato
Satin stainless steel
Edelstahl matt



S-102

Fissaggio a punto Ø 80 con attacco per Sky set 4, set 5.
Point fitting Ø 80 mm with mounting link for canopy Sky set 4, set 5.
Punkhalter Ø 80 mm mit Lasche für Sky Vordach-Set 4, Set 5.

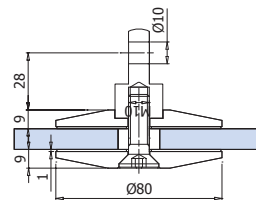

S-104

Piastra di fissaggio inferiore uguale per i set Sky set 4, set 5.
Lower fastening plate suitable for Sky set 4, set 5.
Befestigungsplatte unten passend für Sky set 4, set 5.

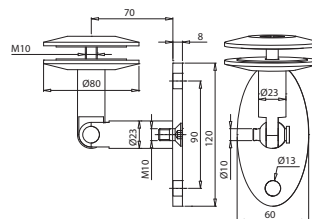

B4-B5

Barra tirante lunghezza standard 1625 mm (B4) 2110 mm (B5) per Sky set 4 e set 5.
Connecting rod standard length 1625 mm (B4) 2110 mm (B5) for Sky set 4, set 5.
Zugstange Lagerlänge 1625 mm (B4) 2110 mm (B5) für Sky set 4, set 5.

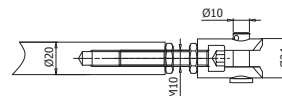

S-105

Piastra di fissaggio superiore con doppio aggancio.
Upper fastening plate with 2 eye links.
Befestigungsplatte oben mit 2 Ösen.

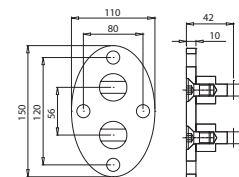

S-106

Punto di fissaggio a 2 vie doppio aggancio Ø 60.
Connector for 2 fixed point fittings Ø 60.
2-arm Punkthalter Ø 60.

